

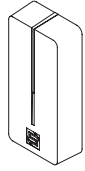

**1**

Unpack box and make sure you have all items shown here.  
(Hex nuts and screws for faceplate mounting included with faceplate)



Reader



Adhesive  
Template



Mounting Screw  
( 2x )



Wall Anchor  
( 2x )

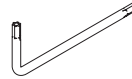

L Key



## IMPORTANT



If mounting the proximity card reader to a surface like a wall or door frame, proceed to **Step A2** on this page.

If mounting the proximity card reader to a controller faceplate, remove the cover plate or existing card reader, keep the hex nuts and screws handy, and proceed to **Step B2** on the next page.

**A2**

Attach included Adhesive Template to mounting surface where required.

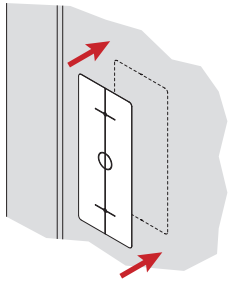

**A3**

Drill mounting and pass-through holes per Template. Mounting holes are not required if not using Wall Anchors.

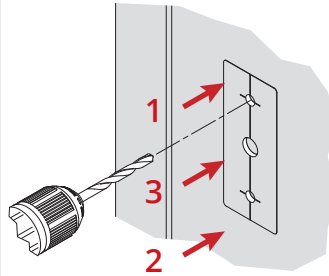

Use 7/16" (6 mm) bit for mounting holes and drill to a depth of 1-1/8" (30 mm).

Use 3/8" (10 mm) bit for pass-through hole.

**A4**

Gently tap in Wall Anchors (if using) with a hammer, and then attach Reader Base with Mounting Screws.

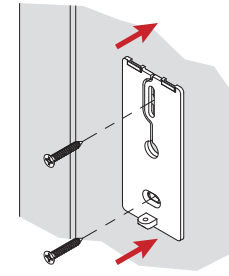

Remove Set Screw from Reader using included L Key to separate Reader from Reader Base.

Set Reader aside.

**A5**

Feed Reader cable through pass-through hole, and connect Reader to Wiegand controller (not included).

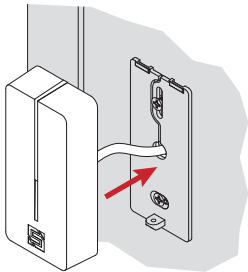

**A6**

Hang Reader on Reader Base, ease into place, and install Set Screw using included L Key.

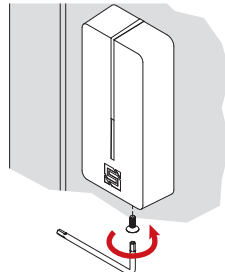

**A7**

Power up Wiegand controller, and make sure Reader is working correctly by scanning a valid card (not included).

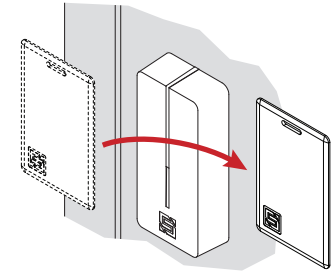

### B2

Attach Reader Base to faceplate using existing hardware, feed Reader cable, and wire to controller (see Section C).

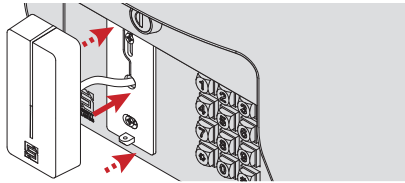

Reader is designed to attach to and connect with Edge E1, E2, E3, and Ascent K2 units (not included). These units come with their own mounting hardware.

### B3

Hang Reader on Reader Base, ease into place, and install Set Screw using included L Key.

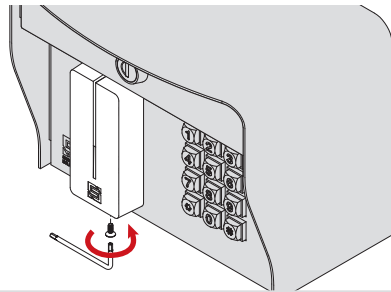

### B4

Power up Wiegand controller, and make sure Reader is working correctly by scanning a valid card (not included).

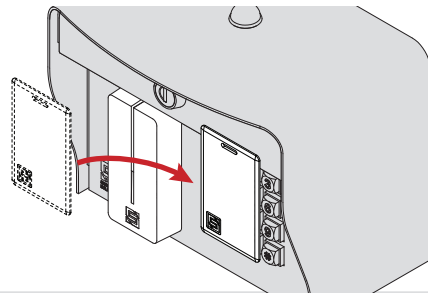

### C

## Typical Wiring

(For many Wiegand controllers including Security Brands controllers)

- ⓘ **IMPORTANT!** Refer to your Wiegand controller manual/instructions for wiring details.
- ⚠ **CAUTION!** Do NOT exceed 13.2 VDC! Overpowering Reader may cause permanent damage!

### Wiegand Controller

Edge (27-210) "Wiegand 1" Terminals Shown

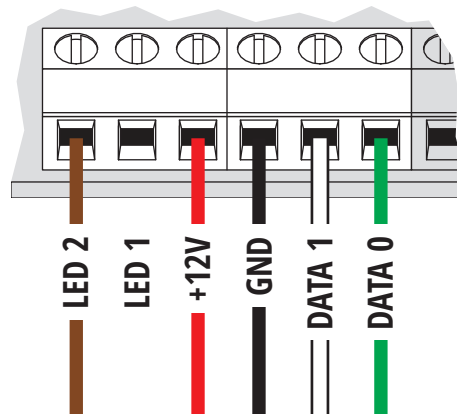

From SecurePass CR Reader

#### Reader Wire Harness Guide

<span style="color: red;">█</span>	Red	+12 VDC
<span style="color: black;">█</span>	Black	Ground (GND)
<span style="color: green;">█</span>	Green	Data 0
<span style="color: white;">█</span>	White	Data 1
<span style="color: brown;">█</span>	Brown	LED
<span style="color: yellow;">█</span>	Yellow	Beeper

ⓘ **NOTE:** Some controllers make use of the yellow "beeper" wire, but it is not required for standard operation and is not used here.

⚠

## WARNING

⚠

**AUTOMATIC GATES CAN CAUSE SERIOUS INJURY OR DEATH!**

**ALWAYS CHECK THAT THE GATE PATH IS CLEAR BEFORE OPERATING!**

**REVERSING OR OTHER SAFETY DEVICES SHOULD ALWAYS BE USED!**

### NEED HELP



Call (972) 474-6390  
Email [techsupport@securitybrands.com](mailto:techsupport@securitybrands.com)

We are available **Mon-Fri / 8am-5pm Central**

