

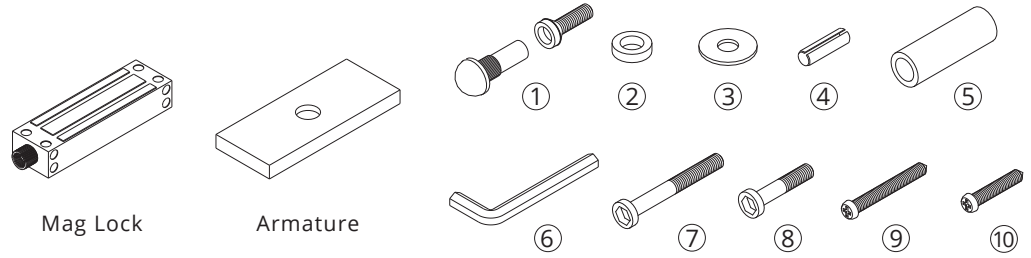

IN THE BOX

Make sure you have everything shown here.



1. Hex Bolt
2. Rubber Washer (2x)
3. Washer (2x)
4. Guide Pin (2x)
5. Door Spacer
6. L Key
7. 60-mm M6 Mounting Screw (4x)
8. 40-mm M6 Mounting Screw (4x)
9. 60-mm M6 Mounting Screw (4x)
10. 50-mm M6 Mounting Screw (4x)

! IMPORTANT!

Specific mounting brackets are required for certain types of gate/door installations. These brackets are sold separately.

Optional Mounting Brackets

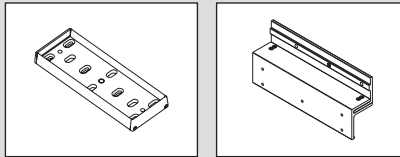

57-BRA1200APH

57-BRA1200Z

INSTALLATION

1. Determine type of gate or door you have. (Refer to **Gate/Door Types** on next page.)

NOTE: Specific mounting brackets are required for certain types of gate/door installations. See above.

2. Determine desired location for mag lock and armature on gate post, and prepare post for mounting mag lock and armature, ensuring there is space for wiring.
3. Remove rubber plugs from necessary holes, and mount mag lock in required orientation using screws suitable for particular installation. (See **Figures 1 and 2.**)
4. Mount armature. (Refer to **Armature Installation.**)
5. Verify proper alignment by closing gate/door and verifying that mag lock and armature make full contact over entire armature length. Adjust as needed.
6. Wire mag lock. (Refer to **Wiring Diagrams.**)
7. Test mag lock for correct operation.

NOTE: Do not complete the last step of installation until you have verified everything is working as required. Removal of the rubber plugs can be difficult.

8. Place rubber plugs into mounting screw access holes on mag lock.

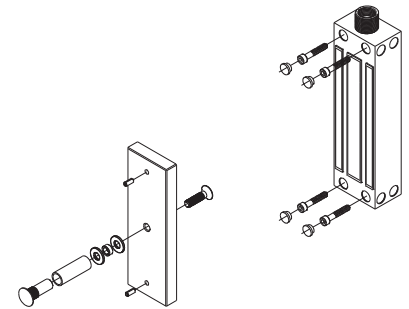

Figure 1: Orientation A

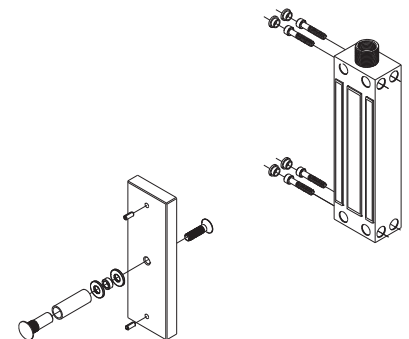
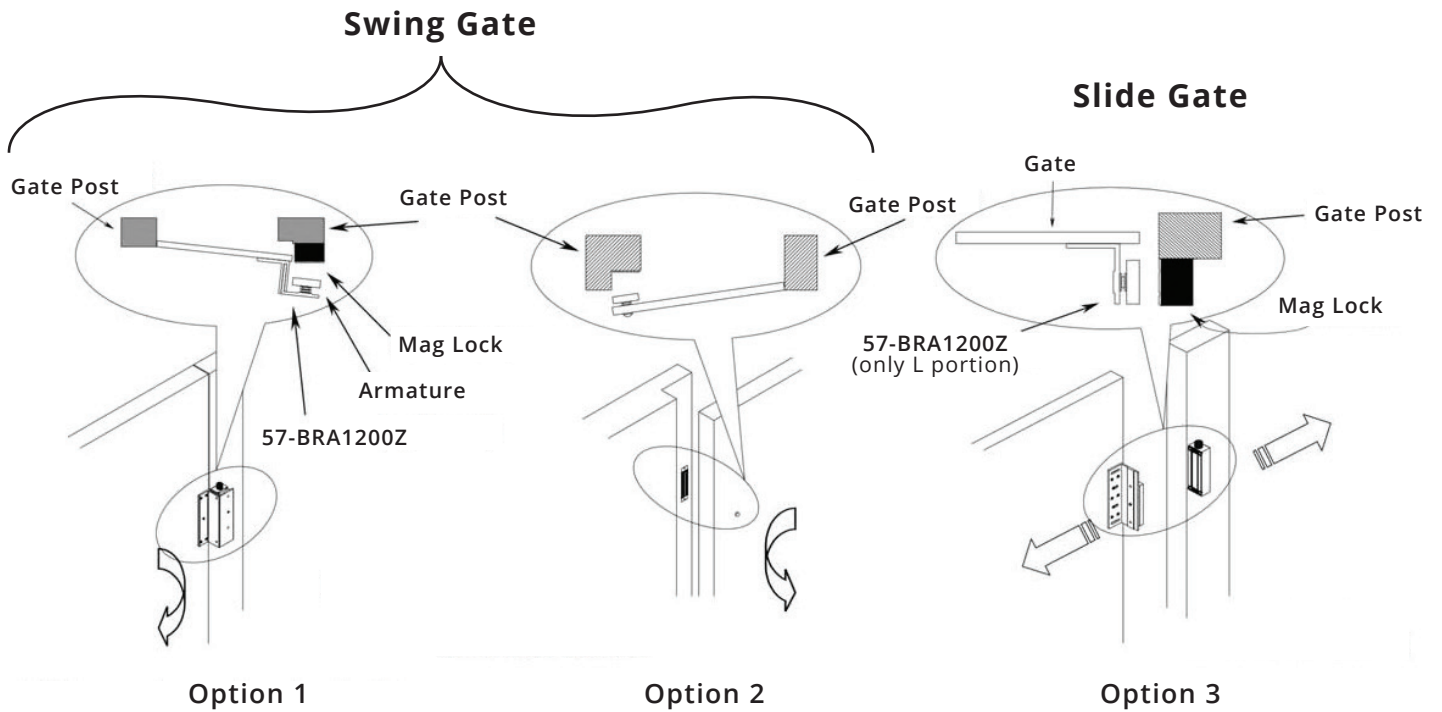
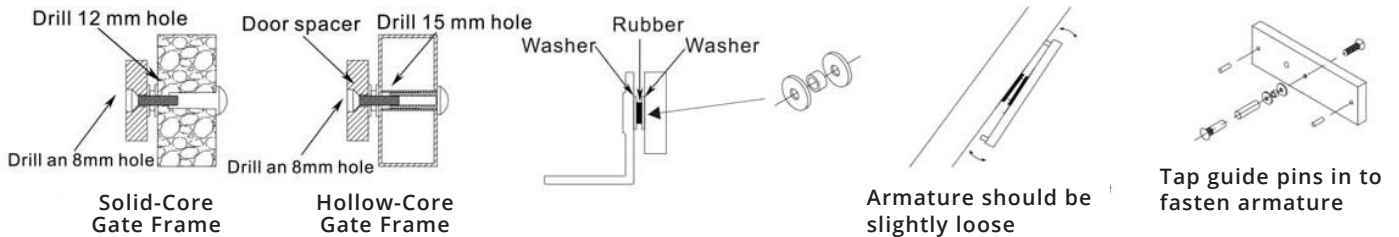

Figure 2: Orientation B

GATE/DOOR TYPES



ARMATURE INSTALLATION



Gate Frame Preparation and Mounting

Guide Pin Installation

WIRING DIAGRAMS

